

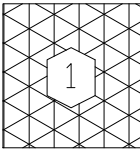
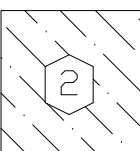

ASBESTOS ABATEMENT - GENERAL NOTES

- A. THE SCOPE OF THE PROJECT IS TO RENOVATE THE EXISTING STRUCTURE AND PROPERLY HANDLE, TRANSPORT, AND DISPOSE OF ASBESTOS CONTAINING BUILDING MATERIALS OF THE STRUCTURE AND ASSOCIATED PROPERTY.
- B. CONTRACTOR SHALL PERFORM ALL WORK, INCLUDING CONTAINMENT MEASURES AND REMOVAL IN ACCORDANCE WITH ALL FEDERAL, STATE AND LOCAL RULES, LAWS AND REGULATIONS AND ANY APPLICABLE VARIANCES AND SITE SPECIFIC VARIANCES. APPLICABLE REGULATIONS INCLUDE, BUT ARE NOT LIMITED TO: OSHA 29 CFR 1236, 40 CFR PART 61 SUBPART M (NESHAP) AND NEW YORK STATE INDUSTRIAL CODE RULE 56.
- C. ALL MATERIAL MEASUREMENTS AND/OR QUANTITIES AND LOCATIONS ARE APPROXIMATE. CONTRACTOR IS RESPONSIBLE FOR FIELD VERIFICATION AT THE JOB SITE AT ALL TIMES.
- D. CONTRACTOR SHALL REFER TO THE ENTIRE DRAWING SET, INCLUDING BUT NOT LIMITED TO ANY ADDENDA AND CLARIFICATION SKETCHES ISSUED AFTER BID, FOR COORDINATION OF NOTES.
- E. IF DURING THE PROJECT WORK, A SUSPECT HAZARDOUS MATERIAL IS FOUND THAT WILL BE IMPACTED BY THE SCOPE OF WORK, AND WHICH HAS NOT BEEN TESTED AS DOCUMENTED IN THE PRE-RENOVATION INSPECTION REPORT, THE CONTRACTOR SHALL CEASE OPERATIONS AND NOTIFY THE OWNER OR OWNERS' REPRESENTATIVE IMMEDIATELY.
- F. ALL MATERIALS REMOVED AS PART OF THIS WORK SHALL BE PROPERLY DISPOSED OF IN COMPLIANCE WITH APPLICABLE FEDERAL, STATE AND LOCAL RULES, LAWS AND REGULATIONS.
- G. FILTERED WASTEWATER SHALL BE DISCHARGED IN ACCORDANCE WITH ALL APPLICABLE FEDERAL, STATE AND LOCAL RULES, LAWS AND REGULATIONS.
- H. THE CONTRACTOR SHALL FURNISH ALL LABOR, MATERIALS, SERVICES, EMPLOYEE TRAINING, PERMITS, INSURANCE AND EQUIPMENT TO REMOVE ASBESTOS AND BUILDING MATERIALS IN LOCATION INDICATED ON CONTRACT DRAWINGS INCLUDING, BUT NOT LIMITED TO THE FOLLOWING:

ASBESTOS ABATEMENT - SPECIFIC NOTES

-  REMOVE FROM THE AREAS INDICATED ALL REPAIR TAR, COUNTERFLASHING CAULKS, FLASHING FELTS, AND HIGH WALL TARS.
-  REMOVE FROM THE AREAS INDICATED ALL REPAIR TARS AT COUNTER FLASHINGS, FLASHING FELTS, CHIMNEYS, ROOF EXHAUSTS, STEP FLASHINGS AND SLATE ROOF PEAKS. REMOVE COUNTERFLASHING CAULKS ADHERED TO REPAIR TARS.
-  REMOVE FROM THE AREAS INDICATED ALL FLASHING FELTS AND REPAIR TARS.
-  REMOVE FROM THE AREAS INDICATED ALL SLATE ROOFING AND REPAIR TAR ADHERED TO THE SLATE ROOFING.
-  REMOVE FROM THE AREAS INDICATED ALL REPAIR TAR FROM COPINGS.

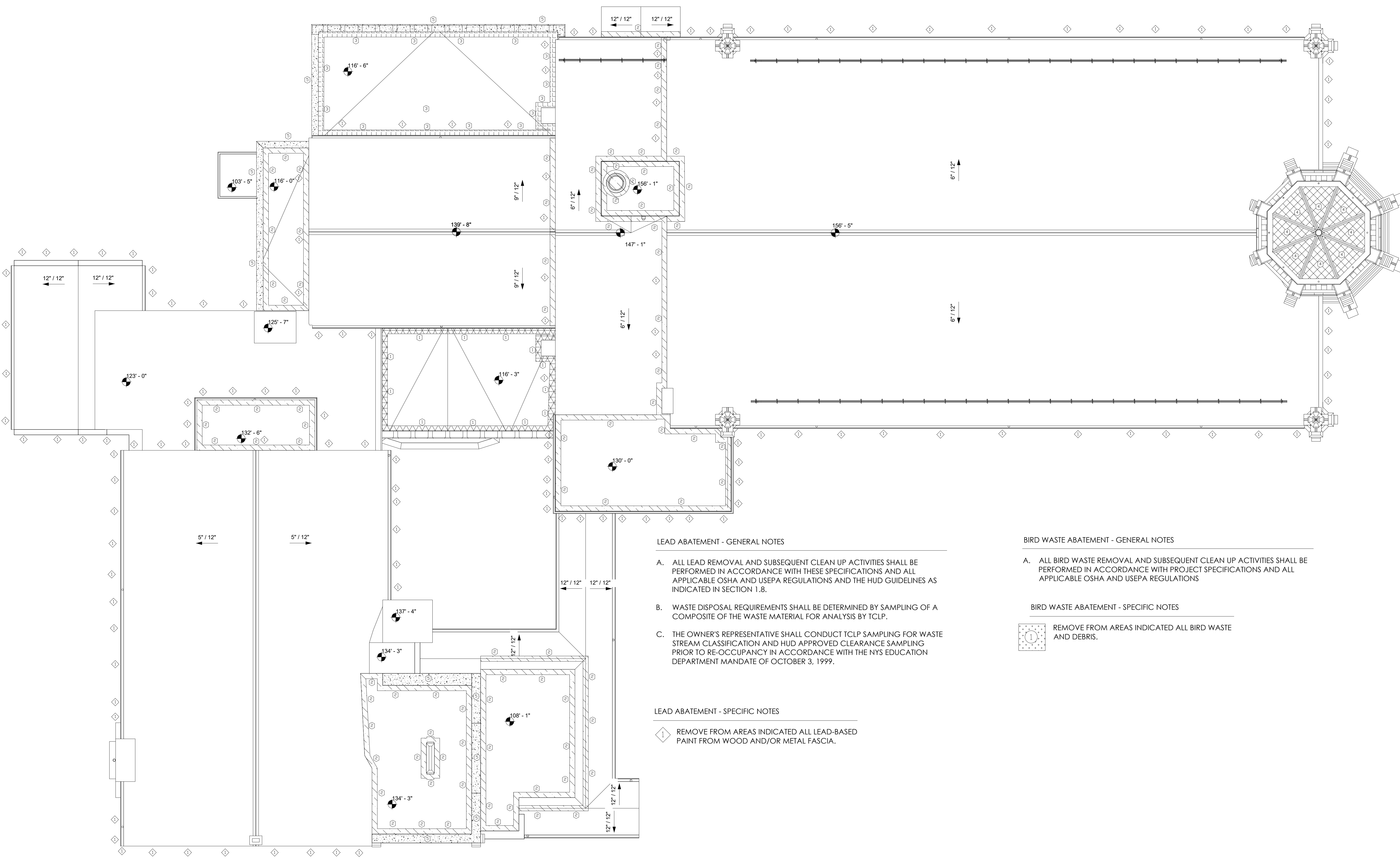

LEAD ABATEMENT - GENERAL NOTES

- A. ALL LEAD REMOVAL AND SUBSEQUENT CLEAN UP ACTIVITIES SHALL BE PERFORMED IN ACCORDANCE WITH THESE SPECIFICATIONS AND ALL APPLICABLE OSHA AND USEPA REGULATIONS AND THE HUD GUIDELINES AS INDICATED IN SECTION 1.8.
- B. WASTE DISPOSAL REQUIREMENTS SHALL BE DETERMINED BY SAMPLING OF A COMPOSITE OF THE WASTE MATERIAL FOR ANALYSIS BY TCLP.
- C. THE OWNER'S REPRESENTATIVE SHALL CONDUCT TCLP SAMPLING FOR WASTE STREAM CLASSIFICATION AND HUD APPROVED CLEARANCE SAMPLING PRIOR TO RE-OCCUPANCY IN ACCORDANCE WITH THE NYS EDUCATION DEPARTMENT MANDATE OF OCTOBER 3, 1999.

LEAD ABATEMENT - SPECIFIC NOTES

-  REMOVE FROM AREAS INDICATED ALL LEAD-BASED PAINT FROM WOOD AND/OR METAL FASCIA.

BIRD WASTE ABATEMENT - GENERAL NOTES

- A. ALL BIRD WASTE REMOVAL AND SUBSEQUENT CLEAN UP ACTIVITIES SHALL BE PERFORMED IN ACCORDANCE WITH PROJECT SPECIFICATIONS AND ALL APPLICABLE OSHA AND USEPA REGULATIONS

BIRD WASTE ABATEMENT - SPECIFIC NOTES

-  REMOVE FROM AREAS INDICATED ALL BIRD WASTE AND DEBRIS.

1 ROOF PLAN
1/8" = 1'-0"

DRAWING SUBMISSION STATUS: [] NOT FOR CONSTRUCTION [] SCHEMATIC DESIGN [] DESIGN DEVELOPMENT [X] CONSTRUCTION DOCUMENTS [] ISSUED FOR CONSTRUCTION

ARCHITECT OF RECORD  172 Allen Street, Buffalo, New York 14201 716.885.0743 • F: 716.885.6414 HHLArchitects.com			ROOFING; REPAIR AND REROOFING Westminster Presbyterian Church 724 DELAWARE AVE BUFFALO, NY, 14209	DRAWING TITLE ROOF PLAN - HAZARDOUS MATERIALS ABATEMENT	SEAL	DATE: 4/16/2019
			PROJECT NUMBER: 1845	REVISIONS AFTER ISSUANCE NO. DATE DESCRIPTION	DRAWING NUMBER HM-100	

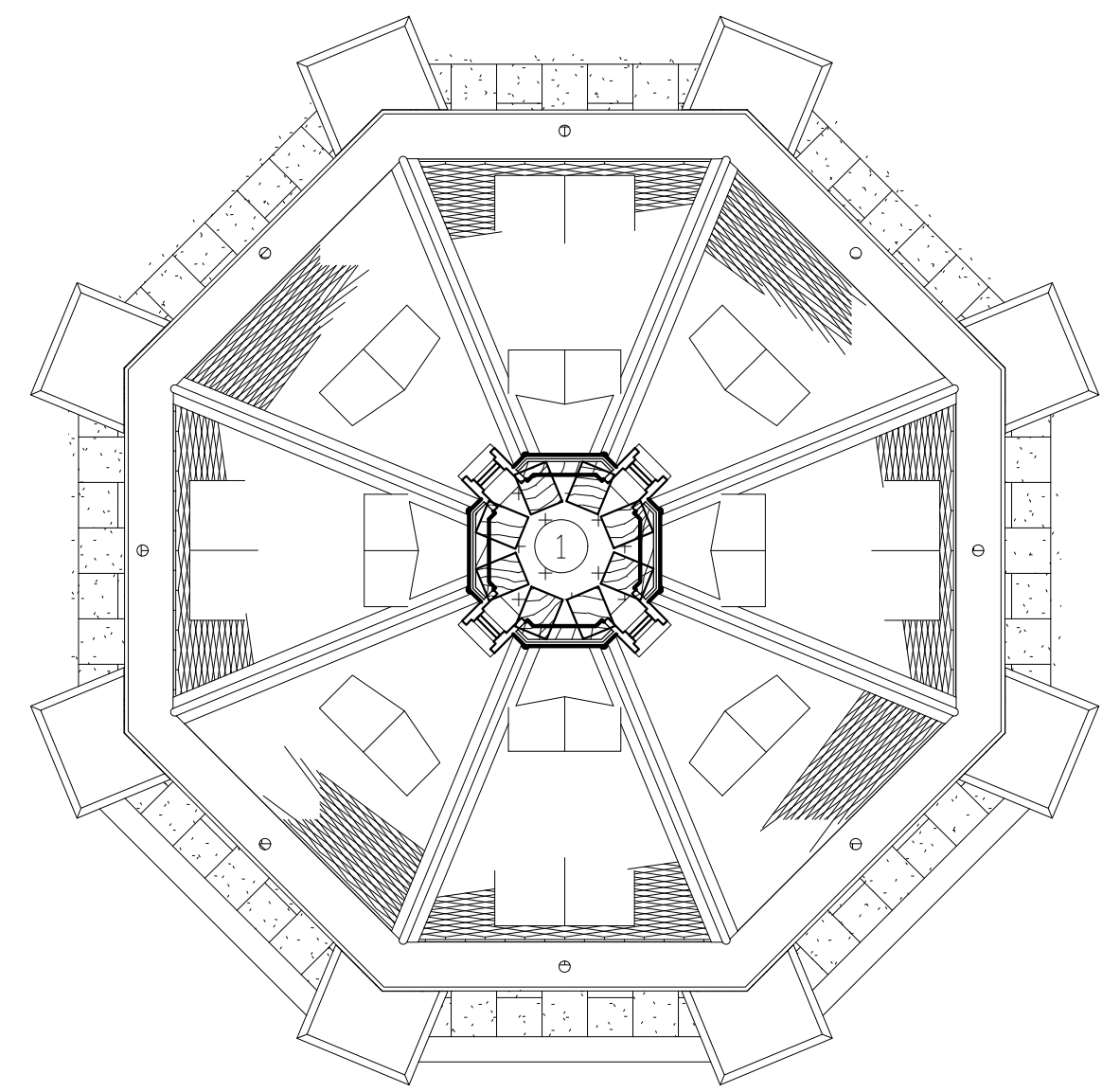

6 ENLARGED PLAN - PLATFORM 4
1/4" = 1'-0"

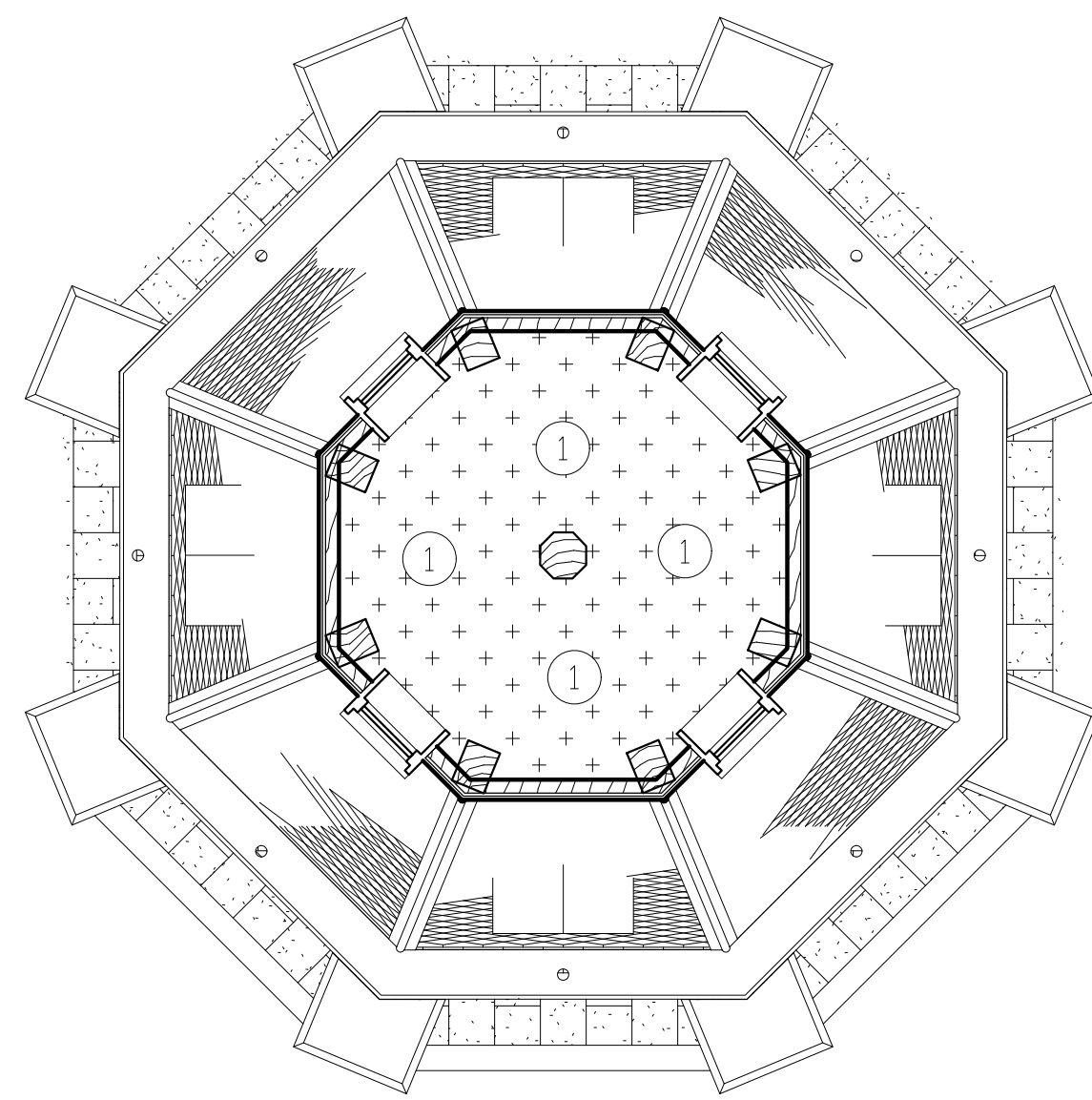

4 ENLARGED PLAN - PLATFORM 2
1/4" = 1'-0"

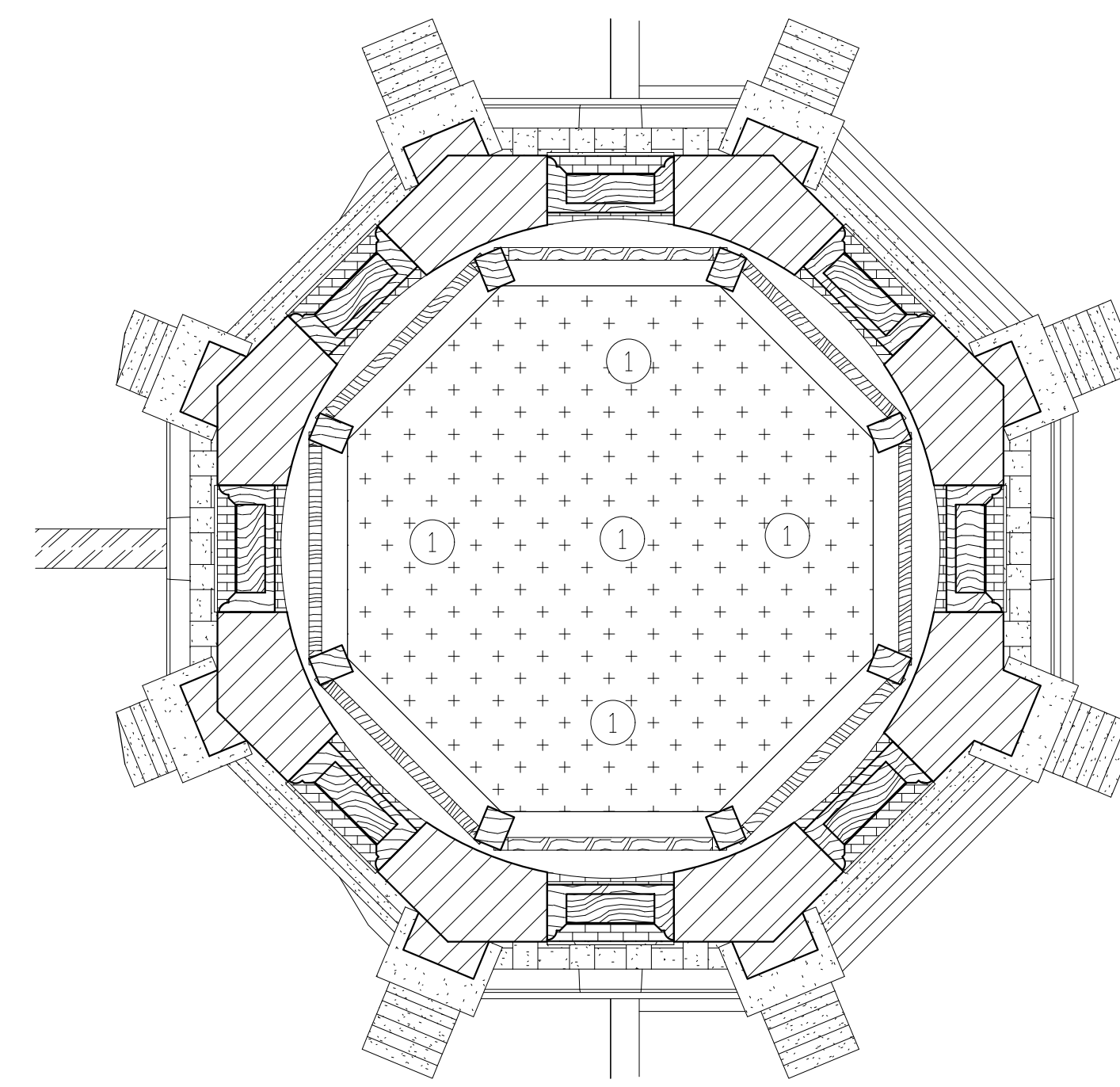

2 ENLARGED PLAN - BELFRY
1/4" = 1'-0"

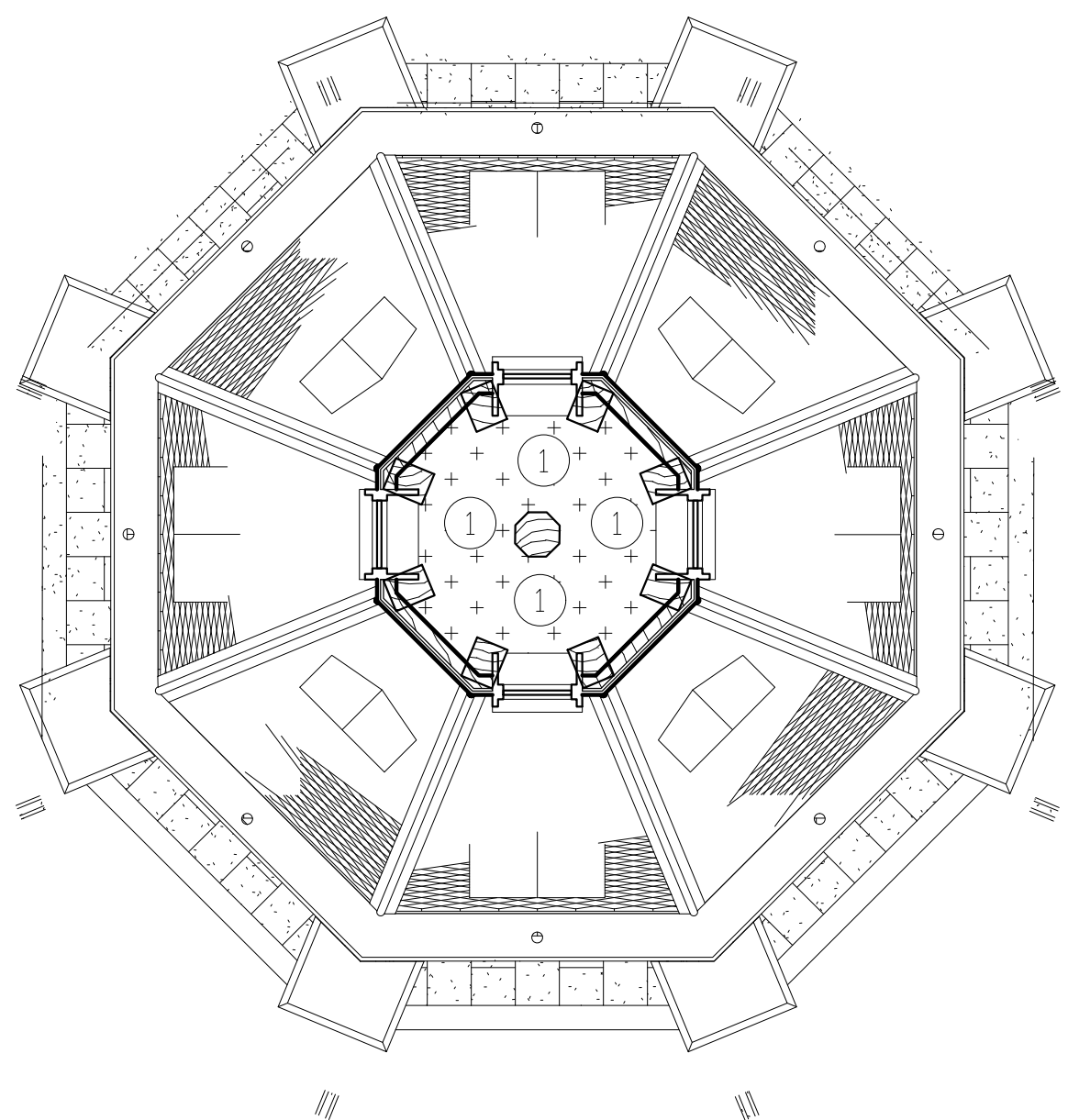

5 ENLARGED PLAN - PLATFORM 3
1/4" = 1'-0"

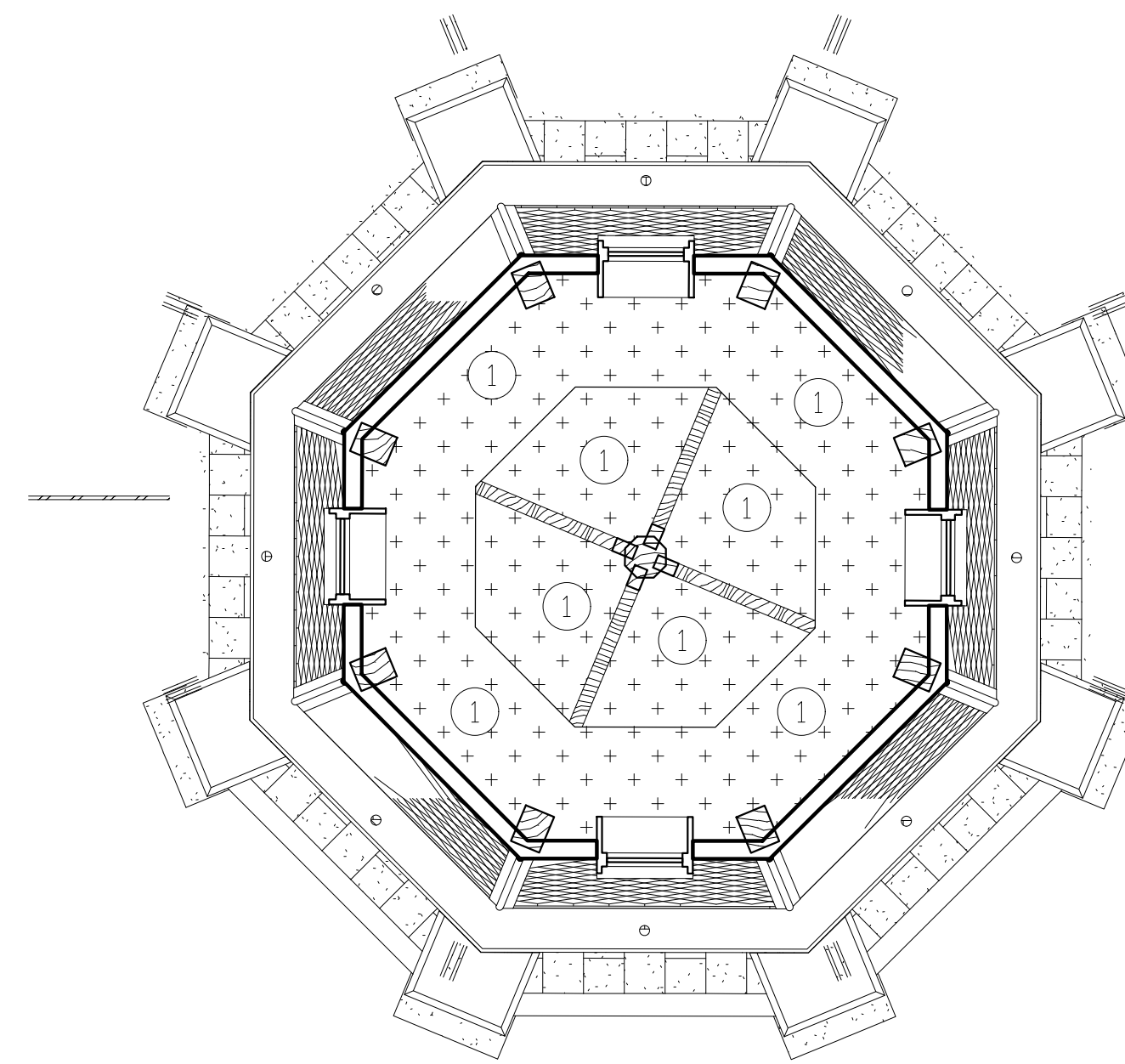

3 ENLARGED PLAN - PLATFORM 1
1/4" = 1'-0"

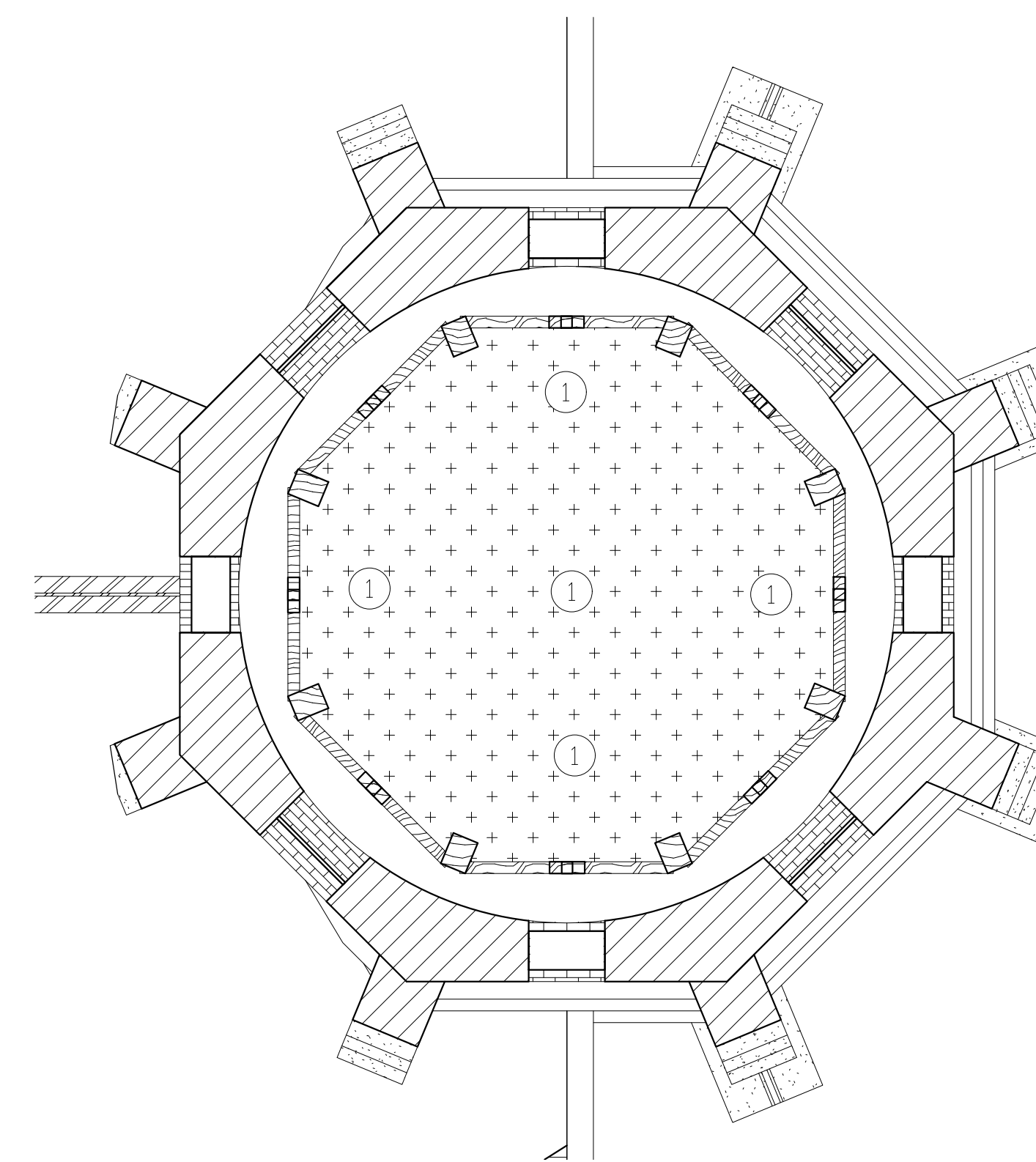

1 ENLARGED PLAN - LANTERN
1/4" = 1'-0"



- A. THE SCOPE OF THE PROJECT IS TO RENOVATE THE EXISTING STRUCTURE AND PROPERLY HANDLE, TRANSPORT, AND DISPOSE OF ASBESTOS CONTAINING BUILDING MATERIALS OF THE STRUCTURE AND ASSOCIATED PROPERTY.
- B. CONTRACTOR SHALL PERFORM ALL WORK, INCLUDING CONTAINMENT MEASURES AND REMOVAL IN ACCORDANCE WITH ALL FEDERAL, STATE AND LOCAL RULES, LAWS AND REGULATIONS AND ANY APPLICABLE VARIANCES AND SITE SPECIFIC VARIANCES. APPLICABLE REGULATIONS INCLUDE, BUT ARE NOT LIMITED TO: OSHA 29 CFR 1236, 40 CFR PART 61 SUBPART M (NESHAP) AND NY STATE INDUSTRIAL CODE RULE 56.
- C. ALL MATERIAL MEASUREMENTS AND/OR QUANTITIES AND LOCATIONS ARE APPROXIMATE. CONTRACTOR IS RESPONSIBLE FOR FIELD VERIFICATION AT THE JOB SITE AT ALL TIMES.
- D. CONTRACTOR SHALL REFER TO THE ENTIRE DRAWING SET, INCLUDING BUT NOT LIMITED TO ANY ADDENDA AND CLARIFICATION SKETCHES ISSUED AFTER BID, FOR COORDINATION OF NOTES.
- E. IF DURING THE PROJECT WORK, A SUSPECT HAZARDOUS MATERIAL IS FOUND THAT WILL BE IMPACTED BY THE SCOPE OF WORK, AND WHICH HAS NOT BEEN TESTED AS DOCUMENTED IN THE PRE-RENOVATION INSPECTION REPORT, THE CONTRACTOR SHALL CEASE OPERATIONS AND NOTIFY THE OWNER OR OWNERS' REPRESENTATIVE IMMEDIATELY.
- F. ALL MATERIALS REMOVED AS PART OF THIS WORK SHALL BE PROPERLY DISPOSED OF IN COMPLIANCE WITH APPLICABLE FEDERAL, STATE AND LOCAL RULES, LAWS AND REGULATIONS.
- G. FILTERED WASTEWATER SHALL BE DISCHARGED IN ACCORDANCE WITH ALL APPLICABLE FEDERAL, STATE AND LOCAL RULES, LAWS AND REGULATIONS.
- H. THE CONTRACTOR SHALL FURNISH ALL LABOR, MATERIALS, SERVICES, EMPLOYEE TRAINING, PERMITS, INSURANCE AND EQUIPMENT TO REMOVE ASBESTOS AND BUILDING MATERIALS IN LOCATION INDICATED ON CONTRACT DRAWINGS INCLUDING, BUT NOT LIMITED TO THE FOLLOWING:

ASBESTOS ABATEMENT - SPECIFIC NOTES

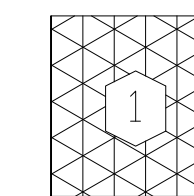

REMOVE FROM THE AREAS INDICATED ALL REPAIR TAR COUNTERFLASHING CAULKS, FLASHING FELTS, AND HIGH WALL TARS.

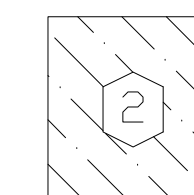

REMOVE FROM THE AREAS INDICATED ALL REPAIR TARS AT COUNTER FLASHINGS, FLASHING FELTS, CHIMNEYS, ROOF EXHAUSTS, STEP FLASHINGS AND SLATE ROOF PEAKS. REMOVE COUNTERFLASHING CAULKS ADHERED TO REPAIR TARS.

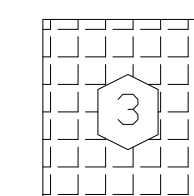

REMOVE FROM THE AREAS INDICATED ALL FLASHING FELTS AND REPAIR TARS.

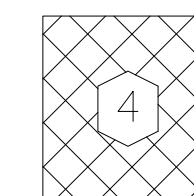

REMOVE FROM THE AREAS INDICATED ALL SLATE ROOFING AND REPAIR TAR ADHERED TO THE SLATE ROOFING.

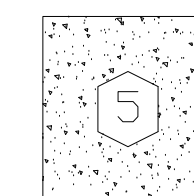

REMOVE FROM THE AREAS INDICATED ALL REPAIR TAR FROM COPINGS.

LEAD ABATEMENT - GENERAL NOTES

- A. ALL LEAD REMOVAL AND SUBSEQUENT CLEAN UP ACTIVITIES SHALL BE PERFORMED IN ACCORDANCE WITH PROJECT SPECIFICATIONS AND ALL APPLICABLE OSHA AND USEPA REGULATIONS AND THE HUD GUIDELINES AS INDICATED IN SECTION 1.8 OF THE SPECIFICATION DOCUMENTS.
- B. WASTE DISPOSAL REQUIREMENTS SHALL BE DETERMINED BY SAMPLING OF A COMPOSITE OF THE WASTE MATERIAL FOR ANALYSIS BY TCLP.
- C. THE OWNER'S REPRESENTATIVE SHALL CONDUCT TCLP SAMPLING FOR WASTE STREAM CLASSIFICATION AND HUD APPROVED CLEARANCE SAMPLING PRIOR TO RE-OCCUPANCY IN ACCORDANCE WITH THE NYS EDUCATION DEPARTMENT MANDATE OF OCTOBER 3, 1999.

LEAD ABATEMENT - SPECIFIC NOTES

- 1 REMOVE FROM AREAS INDICATED ALL LEAD-BASED PAINT FROM WOOD AND/OR METAL FASCIA.

BIRD WASTE ABATEMENT - GENERAL NOTES

- A. ALL BIRD WASTE REMOVAL AND SUBSEQUENT CLEAN UP ACTIVITIES SHALL BE PERFORMED IN ACCORDANCE WITH PROJECT SPECIFICATIONS AND ALL APPLICABLE OSHA AND USEPA REGULATIONS

BIRD WASTE ABATEMENT - SPECIFIC NOTES

- 1 REMOVE FROM AREAS INDICATED ALL BIRD WASTE AND DEBRIS.

ARCHITECT OF RECORD 172 Allen Street, Buffalo, New York 14201 716.885.0743 F: 716.885.6414 HHLArchitects.com			ROOFING: REPAIR AND REROOFING Westminster Presbyterian Church 724 DELAWARE AVE BUFFALO, NY, 14209	DRAWING TITLE LANTERN AND BELFRY PLANS - HAZARDOUS MATERIALS ABATEMENT	SEAL	ISSUE DATE: 4/16/2019
			PROJECT NUMBER: 1845	REVISIONS AFTER ISSUANCE NO. DATE DESCRIPTION	DRAWING NUMBER HM-101	